

SMM5050 SERIES~ SMD Common Mode Choke



PART NUMBERING SYSTEM

SMM	5050	—	601	—	LF
TYPE	DIMENSIONS		IMPEDANCE		LEAD FREE

FEATURES :

- High impedance for common mode noise and low low impedance for differential mode signal .
- Large rated current available .
- High stability due to pair wire windings .
- Wide band or shape type impedance available .
- Lead Free with RoHS compliant .

SHAPES AND DIMENSIONS

UNIT : mm

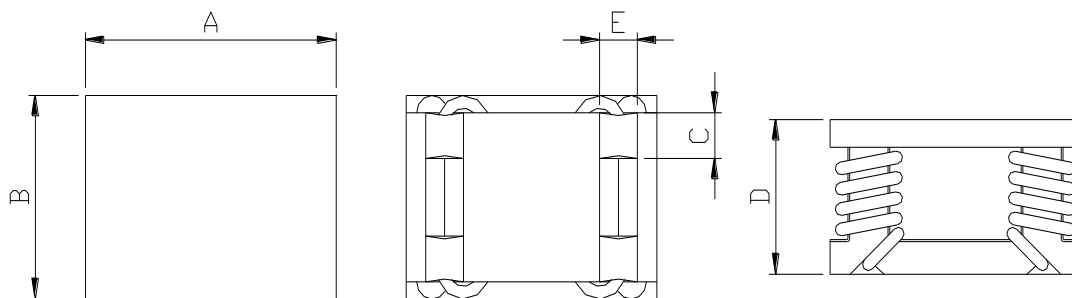

A = 5.0±0.3 B = 8.5±0.30 C = 1.5 Ref. D = 5.0±0.30 E = 1.0 Ref.



SMM5050 SERIES~ SMD Common Mode Choke

SPECIFICATION TABLE

PART NUMBER	IMPEDANCE AT 100MHz	RATED CURRENT (mA)	DCR (mΩ) (Max)	RATED VOLTAGE (Vdc)	INSULATION RESISTANCE (Ω)min
SMM5050-501-LF	500±25%	4000	26.6	50	10M
SMM5050-601-LF	600±25%	4000	27.5	50	10M
SMM5050-701-LF	700±25%	2500	30.0	50	10M
SMM5050-152-LF	1500 Min.	2500	75.0	50	10M
SMM5050-202-LF	1700 Min.	2500	75.0	50	10M
SMM5050-222-LF	2200±30%@50MHz	2500	75.0	50	10M

- Operating temperature range -40°C to +125°C ,
- Electrical specifications at 25°C.

